

YOGHURT - TECHNICAL RIDER

- 1/3

input list

CH.no	Instruments	Mic	Routing F.O.H.	Inserts F.O.H.
1	Kick in	91/e901	Subgroup 1/2	Gate
2	Snare top	sm57	Subgroup 1/2	
3	Hat	KM184	Subgroup 1/2	
4	Tom	Beta98	Subgroup 1/2	Gate
5	Floor	Beta98	Subgroup 1/2	Gate
6	OH <	KM184	Subgroup 1/2	
7	OH >	KM184	Subgroup 1/2	
8	Bass DI/Mic	DI/SM57	Subgroup 3/4	
9	Bass Mic	MD421	Subgroup 3/4	
10	Guit	E906	Subgroup 5/6	
11	B Voc	SM58 (own)	Subgroup 7/8	

12	Voc Lead	E835 (own)	Subgroup 7/8	
13	Voc Lead 2	wireless EW D ME3 G4- B-EU (own)	Subgroup 7/8	

At larger venues, a little reverb on vocals and snare would be appreciated. Definitely NO delay on voice!

In any venue that does not technically exclude it or is not so small that there is no way to walk through it during a gig, lead vocals will use wireless headset microphone (EW D ME3 G4-B-EU). All band-members may use in-ear monitoring (EW IEM G4-B). Sennheiser EW-series base stations for both provided by Yoghurt. In-ear monitoring needs 2 jackplug stereo ins (preferably with foh-endsound), wireless headset microphone base station connects through 1 XLR-microphone cable. Yoghurt provides power adapter for both base stations but needs 1 electric point for it.

YOGHURT - TECHNICAL RIDER

- 2/3

monitor list

Grp.No.	Instruments	Insert
1	Drums	
2	Bass	
3	Lead vocals <	
4	Lead vocals >	
5	Backing vocals/guitar	

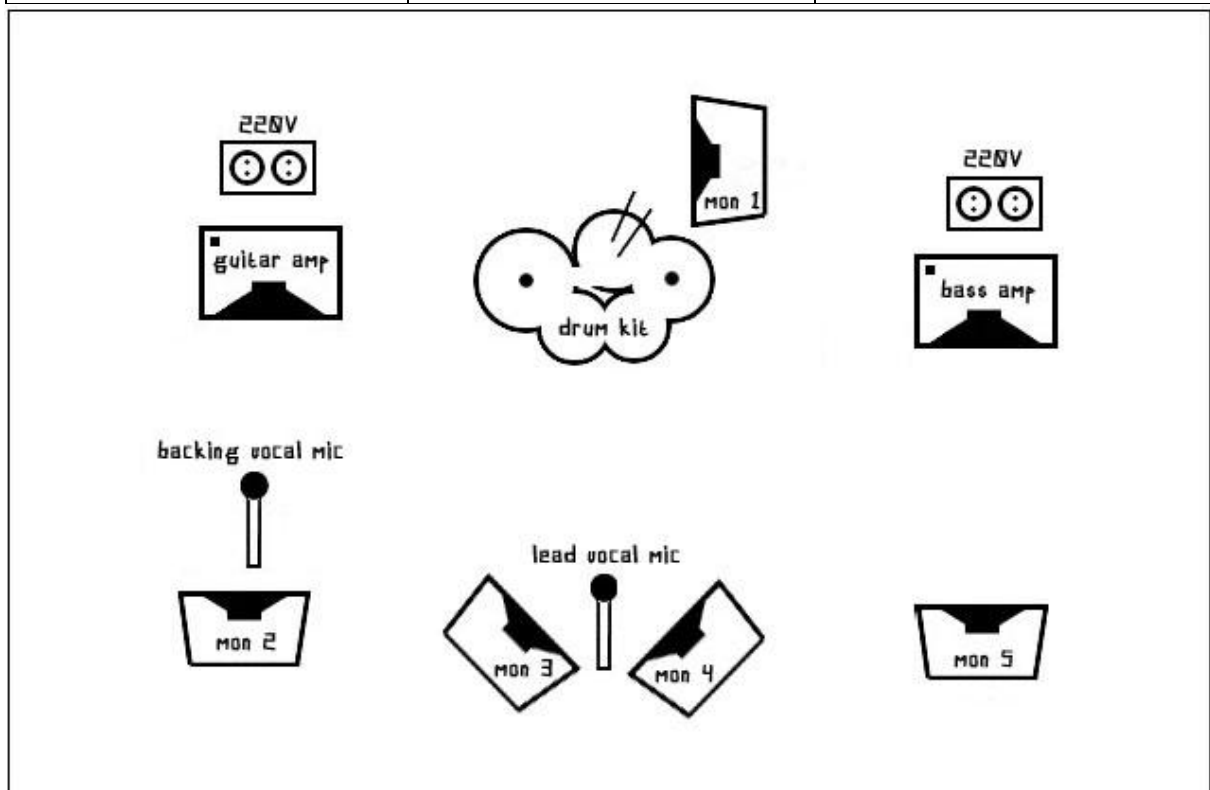

YOGHURT - TECHNICAL RIDER

- 3/3

General

Band members:

Caspar Spilker - guitar, backing vocals

Victor Vos - bass, chapman stick, touch guitar

Chielie - lead vocals

Willem Pieter Barentz - drums, backing vocals

PA/Backline

If no backline is present at venue, we will transport ours in - costs for transport must be paid for by host.